



BS EN877



Eco-Epoxy Coating Cast iron pipes and fittings
for the evacuation of water from building

Fittings Dimension

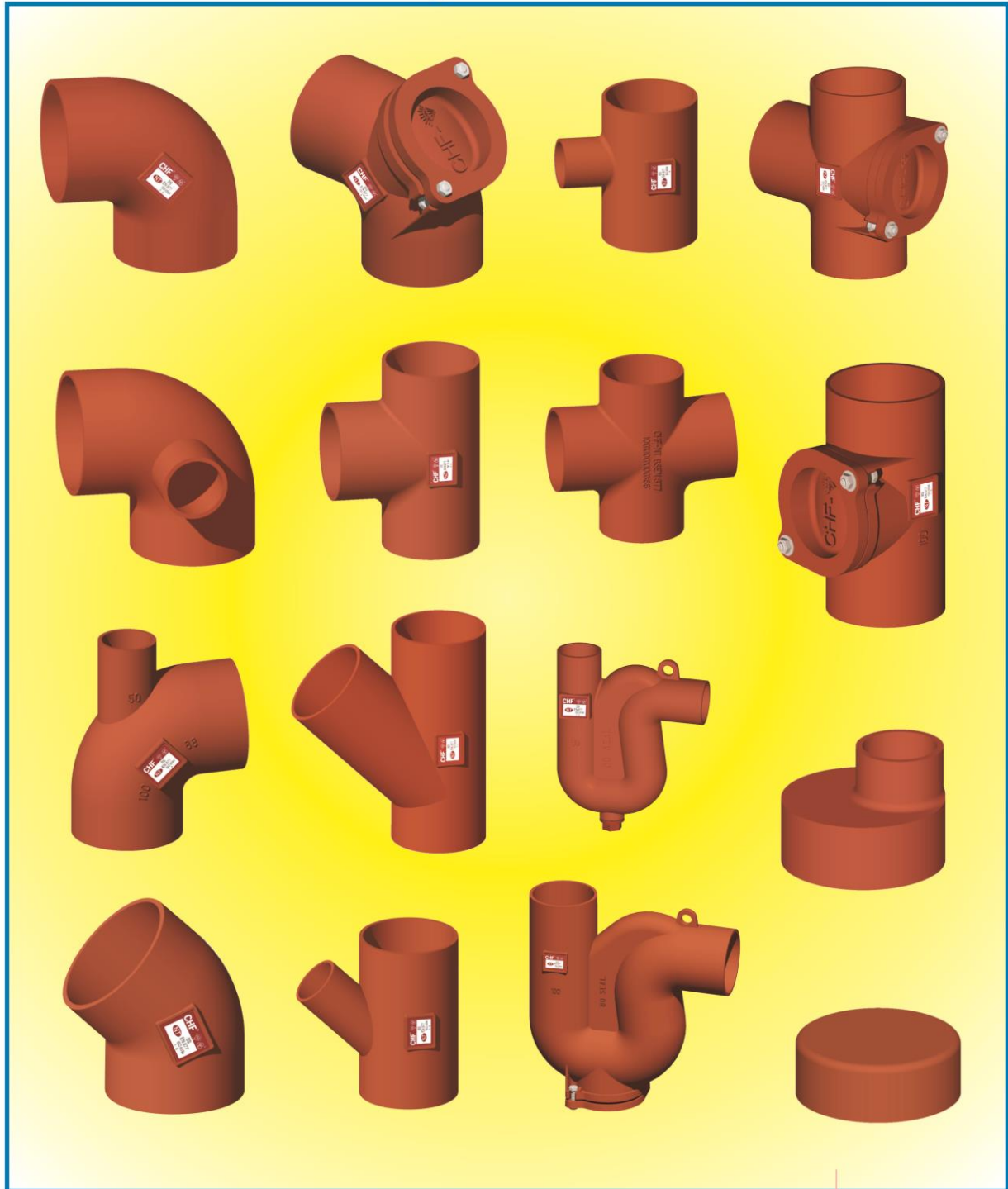

祥興鑄鐵有限公司
CHEUNG HING FOUNDRY (HK) LIMITED

BS EN877

Cast iron pipes and fittings for the evacuation of water from buildings



2. Bends 彎邊

2.1 Bends, 88° 88° 彎邊

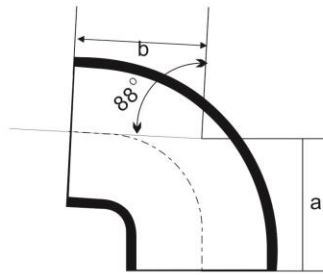

Code No. 貨號	Nominal Bore 公稱內徑 DN	a	b
	mm	mm	mm
NC050A	50	75	75
NC075A	75	95	95
NC100A	100	110	110
NC150A	150	145	145

2.2 Bends, 45° 45° 彎邊

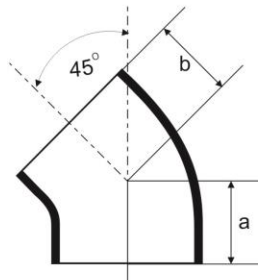

Code No. 貨號	Nominal Bore 公稱內徑 DN	a	b
	mm	mm	mm
NB050A	50	50	50
NB075A	75	60	60
NB100A	100	70	70
NB150A	150	90	90

2.3 Bends, 88° with Access Door 88°正口邊

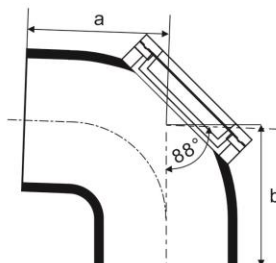

Code No. 貨號	Nominal Bore 公稱內徑 DN	a	b
	mm	mm	mm
NC100B	100	110	110



BS EN877

Cast iron pipes and fittings
for the evacuation of water from buildings



Special Products

* 2.4 Bends, 88° with Top Vent Horn 88°企頭邊

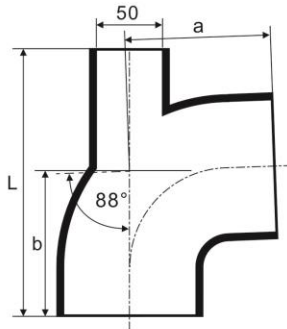
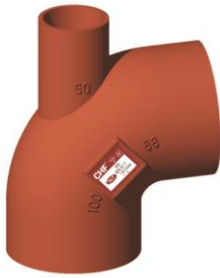

Code No. 貨號	Nominal Bore 公稱內徑 DN	L	a	b
	mm	mm	mm	mm
ND100050A	100 X 50	202	110	110

* 2.5 Bends, 88° with Left / Right Boss 88°左/右預仔邊

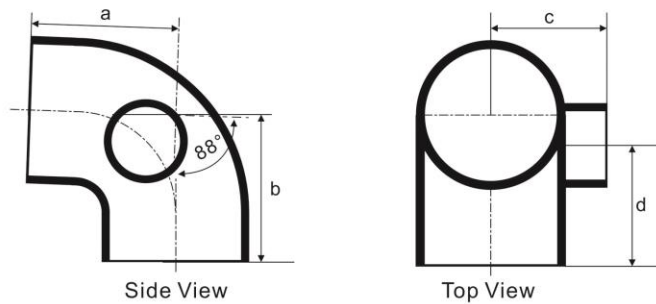
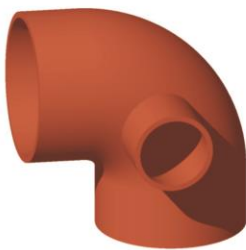

Code No. 貨號	Nominal Bore 公稱內徑 DN	a	b	c	d
	mm	mm	mm	mm	mm
NL100050A	100 X 50	110	110	95	95.5

* Customer made



祥興鑄鐵有限公司
CHEUNG HING FOUNDRY (HK) LIMITED

BS EN877

Cast iron pipes and fittings
for the evacuation of water from buildings



3. Tee 三叉

* 3.1 Tee, 45° Equal 45° 等徑三叉

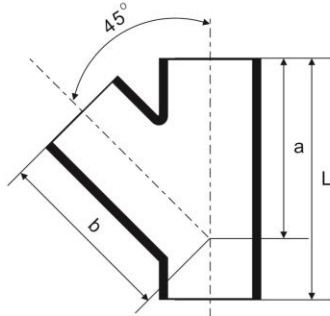

Code No. 貨號	Nominal Bore 公稱內徑 DN	L	a	b
	mm	mm	mm	mm
NF050050A	50	160	115	115
NF075075A	75	215	155	155
NF100100A	100	260	190	190
NF150150A	150	355	265	265

* 3.2 Tee, 45° Unequal 45° 異徑三叉

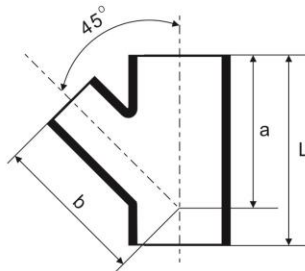

Code No. 貨號	Nominal Bore 公稱內徑 DN	L	a	b
	mm	mm	mm	mm
NF075050A	75 x 50	180	135	135
NF100050A	100 x 50	185	150	150
NF100075A	100 x 75	220	170	170
NF150100A	150 x 100	280	225	225

3.3 Tee, 88° Equal 88° 等徑三叉

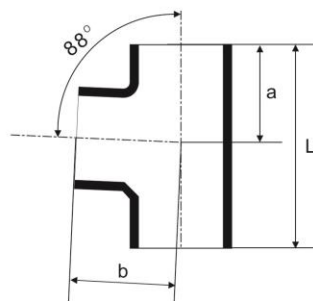

Code No. 貨號	Nominal Bore 公稱內徑 DN	L	a	b
	mm	mm	mm	mm
NE050050A	50	145	65	80
NE075075A	75	185	90	95
NE100100A	100	220	105	115
NE150150A	150	290	150	155

* Customer made



祥興鑄鐵有限公司
CHEUNG HING FOUNDRY (HK) LIMITED

BS EN877

Cast iron pipes and fittings
for the evacuation of water from buildings



3. Tee 三叉

3.4 Tee, 88° Equal with Access Door 88° 正口等徑三叉

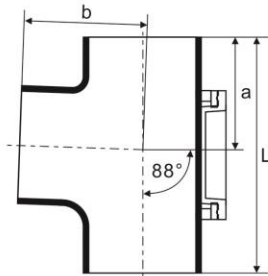

Code No. 貨號	Nominal Bore 公稱內徑 DN	L	a	b
	mm	mm	mm	mm
NE100100B	100	220	105	115

3.5 Tee, 88° Unequal 88° 異徑三叉

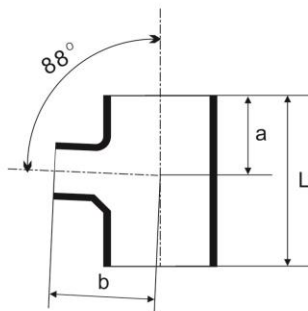

Code No. 貨號	Nominal Bore 公稱內徑 DN	L	a	b
	mm	mm	mm	mm
NE075050A	75 x 50	160	75	92.5
NE100050A	100 x 50	170	77	105
NE100075A	100 x 75	190	91	110
NE150075A	150 x 75	220	105	140
NE150100A	150 x 100	250	125	140

* 3.6 Tee, 88° Double 88° 十字叉

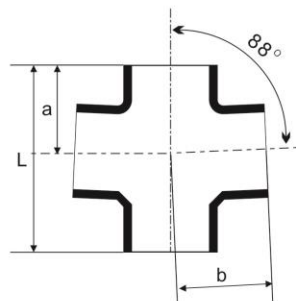

Code No. 貨號	Nominal Bore 公稱內徑 DN	L	a	b
	mm	mm	mm	mm
NR100100100A	100	220	105	115

* Customer made



祥興鑄鐵有限公司
CHEUNG HING FOUNDRY (HK) LIMITED

BS EN877

Cast iron pipes and fittings for the evacuation of water from buildings



Special Products

4 Trap, Anti-Syphon with Access Door 防吸力隔氣

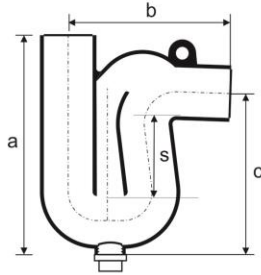

Code No. 貨號	Nominal Bore 公稱內徑 DN	a	b	c	s
	mm	mm	mm	mm	mm
NSA050	50	225	166	165	80

New Design

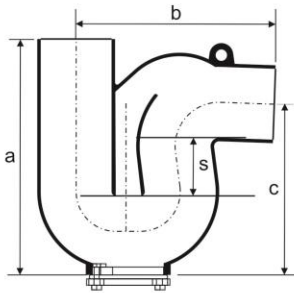

Code No. 貨號	Nominal Bore 公稱內徑 DN	a	b	c	s
	Mm	Mm	Mm	Mm	Mm
NSA075	75	290	240	201	80
NSA100	100	333	280	241	80
NSA150	150	435	379	317	80

5 Short Connecting Pipes with Access Door 有口短坭

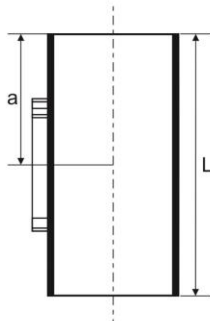

Code No. 貨號	Nominal Bore 公稱內徑 DN	L	a
	mm	mm	mm
NJ050B	50	190	95
NJ075B	75	200	100
NJ100B	100	220	110
NJ150B	150	300	150



BS EN877

Cast iron pipes and fittings
for the evacuation of water from buildings



Special Products

6 Reducers 刁士

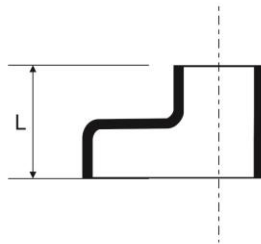
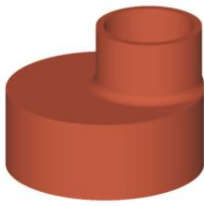

Code No. 貨號	Nominal Bore 公稱內徑 DN x DN	L
	mm x mm	mm
NG075050	75 x 50	80
NG100050	100 x 50	80
NG100075	100 x 75	90
NG150075	150 x 75	100
NG150100	150 x 100	105

7 Plugs 坭積

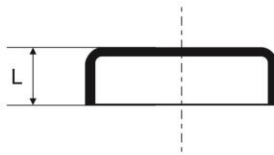
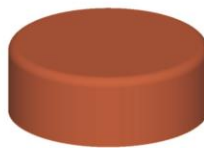

Code No. 貨號	Nominal Bore 公稱內徑 DN	L
	mm	mm
NH050A	50	30
NH075A	75	35
NH100A	100	40
NH150A	150	50



祥興鑄鐵有限公司
CHEUNG HING FOUNDRY (HK) LIMITED

B. Glossary

For the purpose of this European Standard, BS EN877, the following definitions apply:

Discharge system for buildings

System of pipes, fittings, accessories and joints used to collect and drain waste water and rainwater from buildings. It comprises of discharge pipes, stack ventilation and rainwater pipes, installed within the limits of a building or attached to the building.

Drain

System of pipes, fittings, accessories and joints installed outside the limits of a building in order to connect the discharge system of a building to a sewer or a septic tank.

Sewer

System of pipes designed to convey surface water, waste water and rainwater from buildings to a point of disposal or treatment.

Cast iron

Alloy of iron and carbon in which graphite can present in different forms.

Pipe

Casting of uniform bore, straight in axis, having plain ends which can also be socketed.

Fitting

Cast iron component, other than a pipe, which allows, a change of direction or diameter, including flanged and access components.

Accessory

Casting other than a pipe or fitting used in a pipeline.

Joint

Connection between the ends of pipes and/or fittings, including the coupling or clamping component, with sealing effected by elastomeric gasket(s).



C. Annex F of BS EN 877:1999
General Information on some product characteristics

Mechanical resistance and stability



Cast iron products in accordance with relevant British and European Standards are strong enough to withstand abnormal stresses in normal working conditions and possess very good mechanical properties. They withstand, e.g. accidental impact and acts of vandalism. They are not affected by extremes of temperature and do not deteriorate with age.

Safety in case of fire



Cast iron products in accordance with relevant British and European Standards are non-flammable and non-combustible. When exposed to fire, they will maintain their functional characteristics and integrity for several hours. Since their walls are impervious to flames and gases, there will be no fracture, collapse or significant deformation. The integrity of connections through walls and ceilings is maintained.

Hygiene, health and environment



The products conforming to relevant British and European Standards ensure, on a high level, that their walls and joints will not leak under all normal conditions of use. These products are non-toxic and will not constitute any hazard to the hygiene and health of installers or the occupants of the premises. Moreover, these products are entirely recyclable without residual waste.

Noise protection



Cast iron pipe systems, due to the high mass per unit area of their pipe walls as well as the joint design characteristics, provide considerable noise reduction when evacuating wastewater within buildings. Additional protection is therefore not required.